

AHC-RS



Family features:

- ▶ Hall Sensor available
- ▶ Degree of protection: IP 50
- ▶ Operation mode: S2 - S3
- ▶ Linear movement

Voltage	Part number	I _n (Nominal current)	F _n (Nominal force)	F _{max} Maximum force	Adjustment speed	Stroke	Signal	Dimensional drawing (D)	Wiring diagram (W)	Connector (C)	Performance curve (P)
12 V	0 390 203 229	9	0.5	3	13	81.6	Yes	D3	W1	C3	P3
	6 004 RA3 645	5	0.3	3.2	9.0	34.7	Yes	D1	W2	C1	P1
	0 390 201 941	3.9	0.5	4.5	7.2	75	No	D2	W3	C2	P2
	0 390 201 989	6	0.5	4.25	7	58.5	Yes	D4	W1	C3	P4

D1

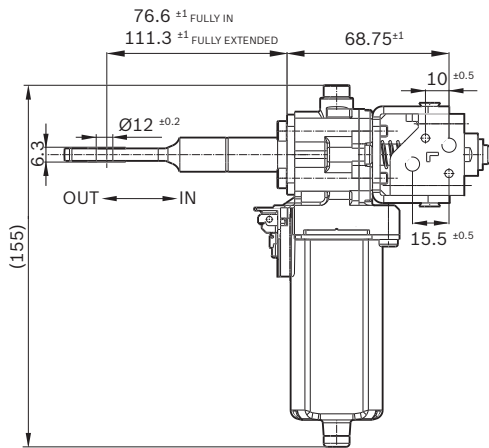

D2

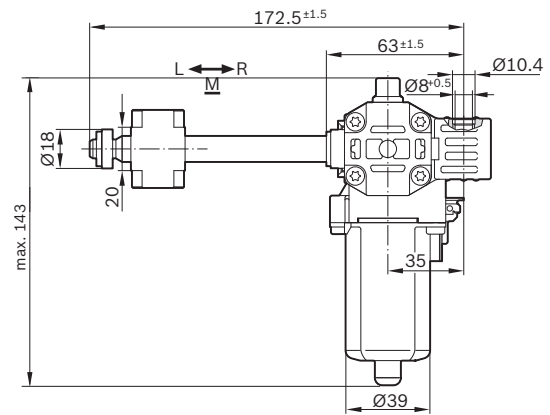

D3

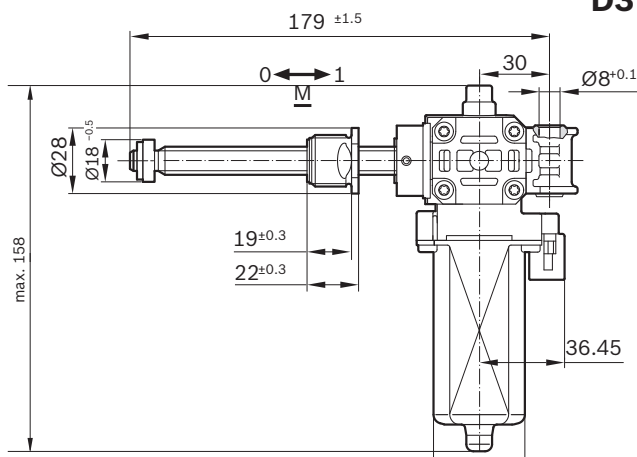

D4

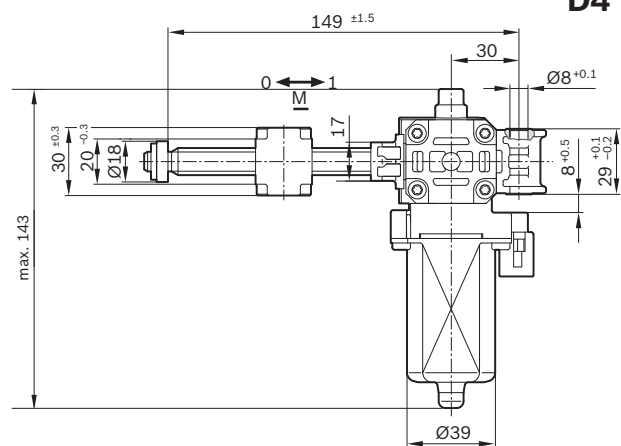

AHC-RS

Wiring diagram (W)

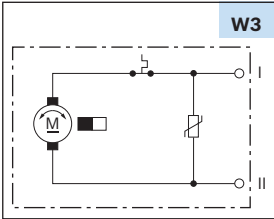
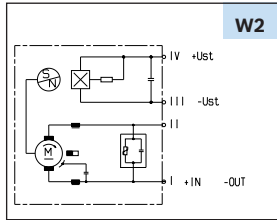
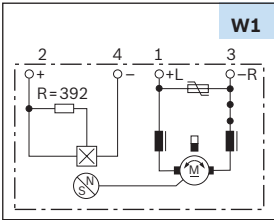

Mating connector (C)

C1

Housing: TE 968182-1
 Locker: TE 968183-1
 Terminal: TE JPT 927768-1 (x2)
 TE MT III 968052-1 (x2)

C2

Housing: TE 968182-1
 Locker: TE 0-968183-1
 Terminal: TE JPT 0-927768-1 (x2)

C3

Housing: FCI 3 023 59 01
 Locker: -
 Terminal: TE MQS PIN Contact 6-928918-1
 Pin 0.63 x 0.63 mm / TE MPQ
 Pin 2.8 x 0.63 968137-2 2.80 mm

Performance curve (P)

